

# EXHAUST AIR VALVE DVS

## TECHNICAL DATA

**DVS** is an exhaust valve suitable for houses, offices etc.

- Good adjusting features
- Low noise level
- Quick and easy to install
- Airflow easy to measure

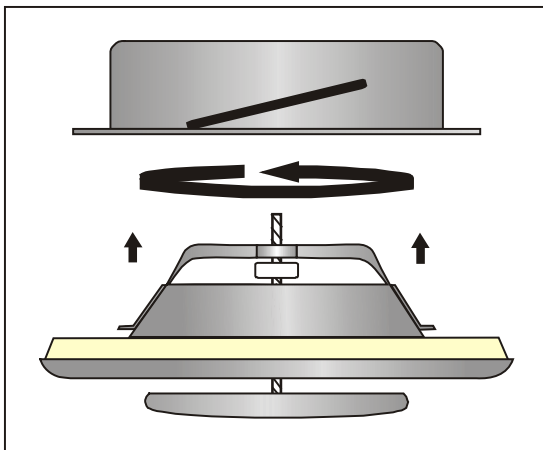

## CONSTRUCTION

The **DVS** is manufactured from steel sheet, powder coated. Standard color white (RAL 9010). Other color finishes are available to special order quantities.

The valve body has a gasket, made of cellular plastic and the control disc, with screw spindle, enables easy regulation and positional locking.

Fixing collar **DVS-F** is manufactured from galvanized steel sheet.

## REGULATION AND MEASUREMENTS

Regulation of airflow is achieved by turning the control disc to change adjustment dimension  $s$  (mm). The measurement of airflow is made by a pressure difference measurement with a separate measuring tube.

Refer to airflow measurement diagrams for information.

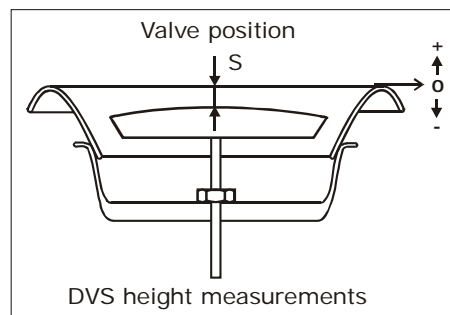

**ORDER EXAMPLE:** Powder coated valve *including* fixing collar **DVS-F**  
Product: DVS  
Size: 100  
**CODE:** DVS100

The information contained in this brochure was current on the publication date. The Company reserves the right to make changes in details at any time without prior notice. In order to avoid misunderstandings, any interested party is advised to contact the Company checking for any changes in materials and/or information after this brochure was published.

Version 2006 [www.decinternational.com](http://www.decinternational.com)

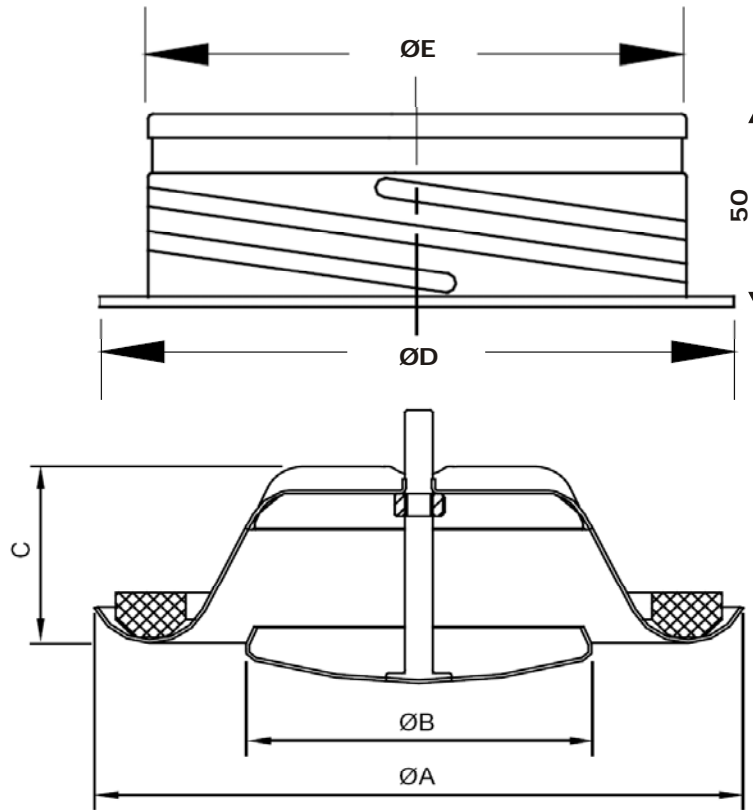

## DIMENSIONS IN MILLIMETRES

DVS	Ø 080	Ø 100	Ø 125	Ø150	Ø 160	Ø200
A	116	140	170	202	202	254
B	60	75	99	119	119	157
C	40	40	46	54	54	64
Weight	150 gr	160 gr	230 gr	340 gr	340 gr	510 gr
D	105	125	150	175	185	225
E	79	99	124	149	159	199
Weight	80 gr	100 gr	120 gr	180 gr	190 gr	240 gr

The information contained in this brochure was current on the publication date. The Company reserves the right to make changes in details at any time without prior notice. In order to avoid misunderstandings, any interested party is advised to contact the Company checking for any changes in materials and/or information after this brochure was published.

Version 2006 [www.decinternational.com](http://www.decinternational.com)

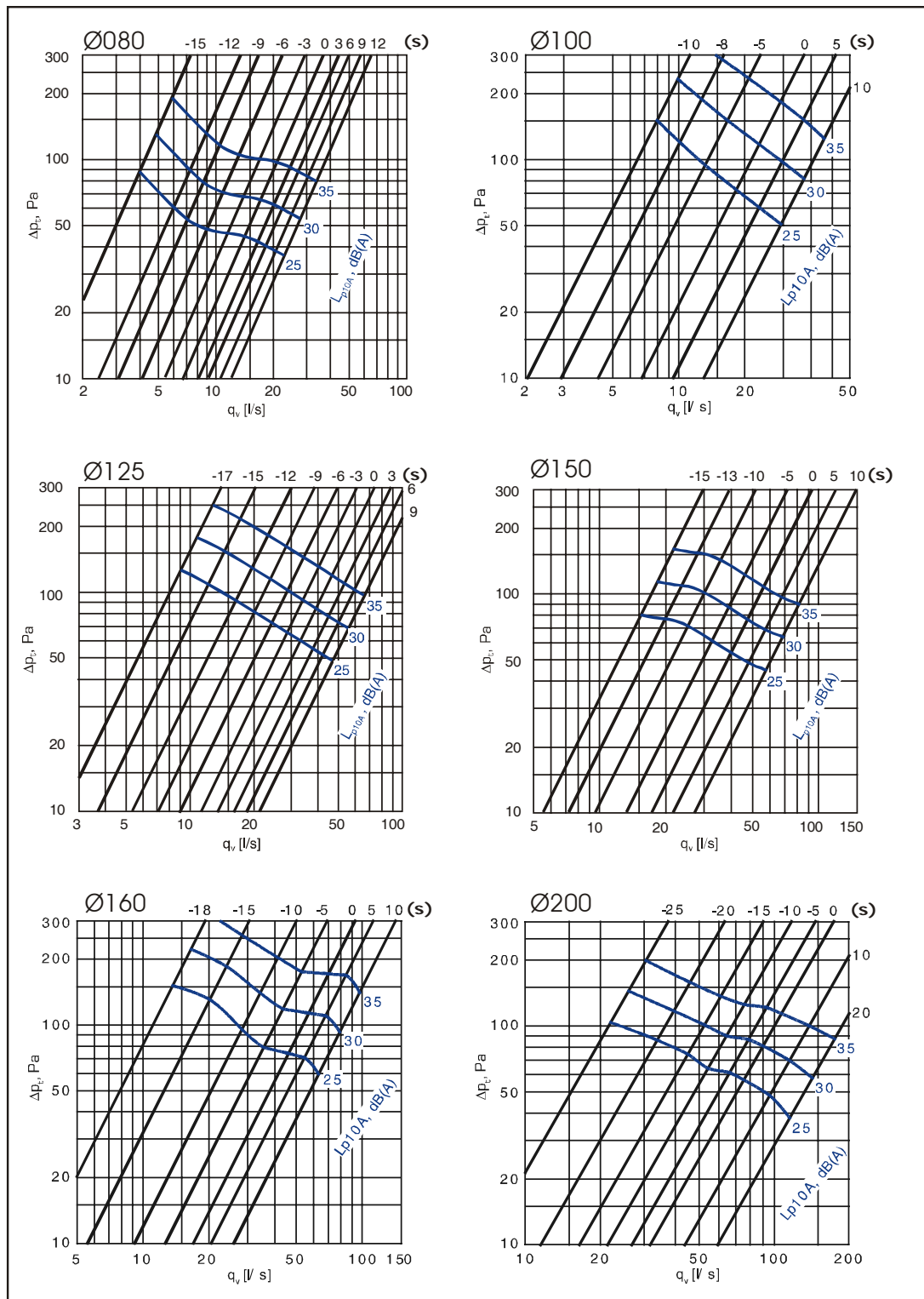

## DVS 3.5a

The information contained in this brochure was current on the publication date. The Company reserves the right to make changes in details at any time without prior notice. In order to avoid misunderstandings, any interested party is advised to contact the Company checking for any changes in materials and/or information after this brochure was published.

Version 2006 [www.decinternational.com](http://www.decinternational.com)

## SOUND POWER LEVEL $L_w$

DVS	CORRECTION $K_{oct}$ (dB)						
	Middle frequency by octave band (Hz)						
	125	250	500	1000	2000	4000	8000
080	1	-2	1	0	-3	-10	-22
100	5	-2	-3	-3	0	-8	-20
125	-6	0	0	-3	0	-13	-25
150	-6	-5	-4	0	-1	-13	-28
160	1	-1	-3	1	-2	-15	-32
200	3	1	-1	1	-4	-12	-25
Tol. +/-	3	2	2	2	2	2	3

Sound power levels by octave bands are obtained by adding to total sound pressure level  $L_{p10A}$ , dB(A) the corrections  $K_{oct}$  presented in the table according to the following formula:

$$L_{woct} = L_{p10A} + K_{oct}$$

Correction  $K_{oct}$  is average value in range of use of **DVS** unit.

## DEFINITIONS

$q_v$	air volume	(m <sup>3</sup> /h)
$\Delta p_t$	total pressure drop	(Pa)
$L_{p10A}$	sound pressure level with 4 dB room attenuation (10 m <sup>2</sup> sab)	[dB(A)]
$L_{woct}$	sound power level by octave bands	(dB)
$\Delta L$	sound attenuation	(dB)
$K_{oct}$	correction	(dB)

DVS	Adjustment s (mm)	SOUND ATTENUATION $\Delta L$							
		Middle frequency by octave band (Hz)							
		63	125	250	500	1000	2000	4000	8000
080	-9	24	20	14	10	8	5	5	6
	0	24	19	13	9	6	3	4	5
	12	24	19	13	9	5	2	3	4
100	-10	23	19	14	12	11	10	13	14
	0	23	16	11	8	7	6	9	8
	10	23	16	11	7	5	4	7	8
125	-17	20	19	13	10	7	7	11	14
	0	18	16	10	6	4	4	5	8
	9	19	16	9	6	3	3	5	7
150	-15	21	14	11	8	6	6	8	8
	0	20	13	9	6	4	4	7	6
	10	16	14	9	4	3	2	7	7
160	-15	18	13	11	7	6	6	8	8
	-10	18	13	10	6	5	5	7	7
	0	17	13	9	5	4	3	6	6
200	-15	17	12	8	7	6	7	8	9
	-5	17	11	7	6	5	6	6	8
	0	17	11	7	5	5	6	6	7
Tol. $\pm$	6	3	2	2	2	2	2	2	3

The average sound attenuation  $\Delta L$  from duct to room including the end reflection of the connecting duct in ceiling installation is obtained in the table above.

The information contained in this brochure was current on the publication date. The Company reserves the right to make changes in details at any time without prior notice. In order to avoid misunderstandings, any interested party is advised to contact the Company checking for any changes in materials and/or information after this brochure was published.

Version 2006 [www.decinternational.com](http://www.decinternational.com)