

ADJUSTABLE SLOT DIFFUSER SB600

Installation dimensions

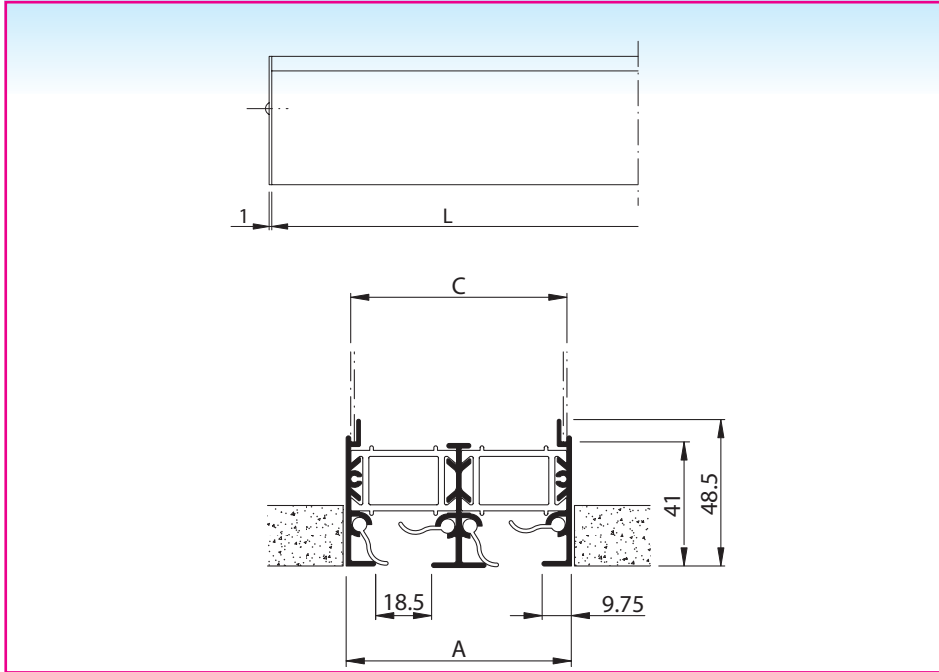

	Number of slots				
	1	2	3	4	5
A	38	74,5	111	147,5	184
C	34,5	71	107,5	144	180,5

L = slot length

All dimensions in mm.

Fast selection diagram

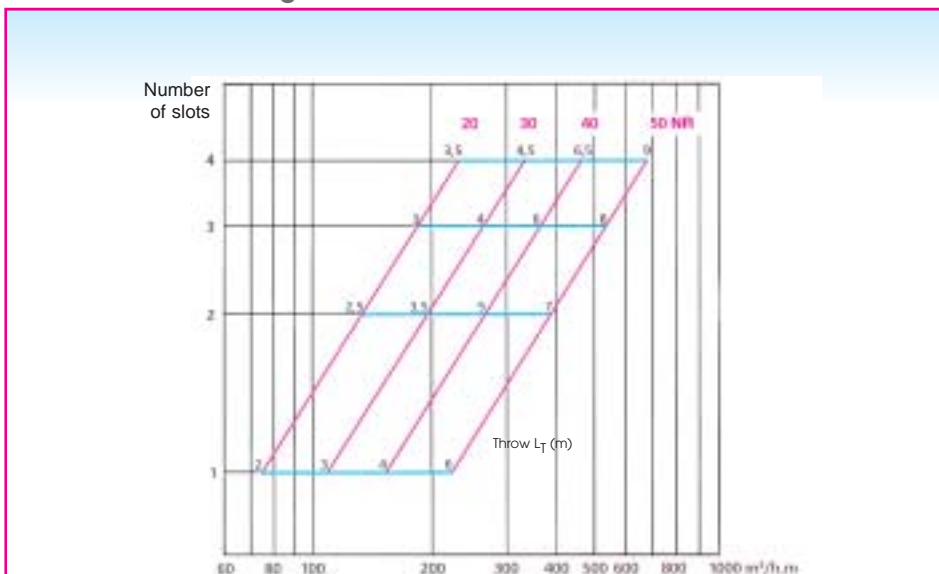

Throw factor is based on a v_R of 0,17 m/s in the occupied zone.
See page 4 012 for a detailed selection

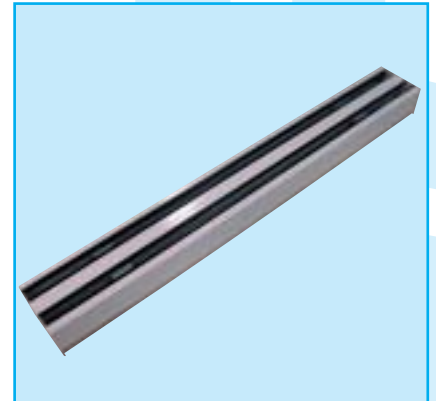

Application

The slot diffuser, type SB600 is used for the supply of cooled and heated air in facilities such as offices, shops, meeting rooms, ...

It is designed for installation in the ceiling or sidewall and is available from 1 to 5 slots. Each slot is individually adjustable and equipped with 2 deflector vanes of a special design to minimise the internal turbulences. Also one can obtain an ideal air supply pattern adjustable over 180°.

All lengths are available so that the diffuser fits ideally in every ceiling-system.

Technical information

Characteristics

- available up to 5 slots
- all lengths available (in steps of 1 mm): from 300 mm up to 2000 mm in one piece
- none operational parts or dummy diffusers; slots are closed by black PVC strips (SB650)
- exhaust: without deflectors
- supply: horizontal or vertical air supply pattern possible by adjustable deflectors

Adjusting possibilities :

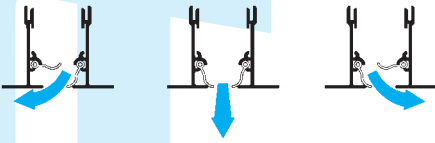

- available with plenum :
 - with or without damper in the inlet
 - up to a length of 1600 mm supplied with one circular inlet spigot, over 1600 mm : two circular inlet spigots

Construction

- slot diffusers out of natural tone anodised aluminium, with deflectors in black extruded aluminium
- construction with deflectors in white extruded aluminium, diffuser standard satin anodised
- plenum out of galvanised sheet steel, with or without insulation

Specifications description

Example :

Aluminium linear diffuser with 2 supply slots and adjustable deflectors. Complete with fixed mounted plenum, insulated at the inside, with circular side inlet spigot and damper. Diffuser natural tone anodised, black aluminium deflectors.

Type : SB612 + SP132 G
L = ... mm

Accessories

BOBSE : blanking off baffle; made out of steelplate, painted in black (RAL9005)

Fixing

- concealed fixing
- direct and fixed mounting of the diffuser on the plenum (mounting Grada on demand)
- provided with mounting eyes (ø 7mm), mounting straps available on demand

How to order

SB600 with 2 slots and black aluminium deflectors, slot length 1000 mm.

S	B	6	1	2	-	-	1	0	0	0	-	-	-	-
---	---	---	---	---	---	---	---	---	---	---	---	---	---	---

slot length (mm)

- : slot diffuser in one piece with end caps on both sides
- E : end pieces, with one end cap
- M: intermediate piece, without end caps

number of slots

- 0 : exhaust, no deflectors
- 1 : supply, with **black** aluminium deflectors
- 2 : supply, with **white** aluminium deflectors
- 5 : dummy diffuser