

VOLUME FLOW CONTROLLER HNDCVR

Installation dimensions

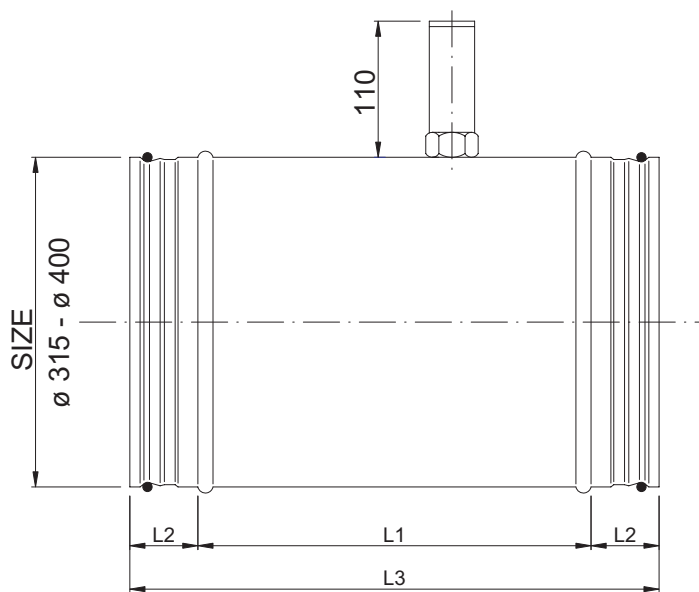
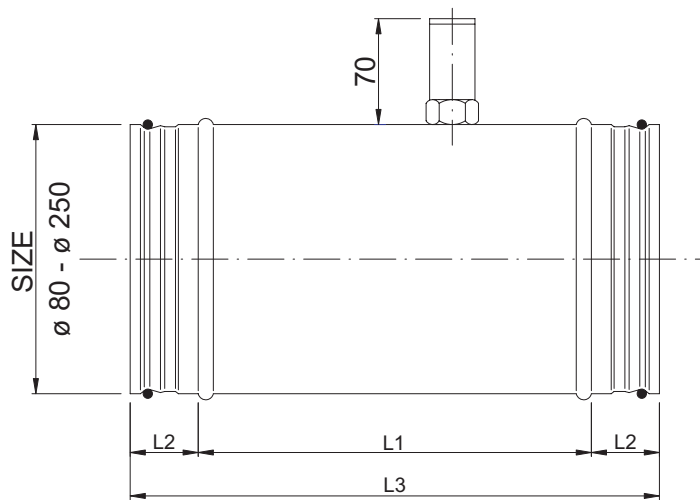

L₁ = installation length

Selection table

SIZE (mm)	Airflow m ³ /h		Dimensions in mm		
	min.	max.	L ₁	L ₂	L ₃
80	40	125	120	40	200
100	70	220	170	40	250
125	100	280	170	40	250
140	140	400	170	40	250
160	180	500	240	40	320
200	250	900	240	40	320
250	500	1500	240	40	320
315	800	3000	220	60	340
400	1000	4500	295	60	415



Application

The round mechanical constant volume control, type HNDCVR, is suitable for both the supply and the discharge of air in both high and low pressure systems alike. The control keeps the air quantity constant (CAV) without auxiliary power and independent of the static initial pressure. The air flow is set at the factory, with adjustment possible within the whole control range by means of graduation.

Technical information

Characteristics :

- suitable for air quantities of 40 to 4,500 m³/h
- available in 9 sizes
- operating temperature:
 - 30°C to + 100°C
- differential pressure range: minimum differential pressure (see diagram 1) to maximum 1000 PA
- air quantity - control precision: +/- 10% (if <100 m³/h, variation to 10 m³/h)
- recommended air speed: 4.5 m/s (minimum 2.7 m/s)
- low own resistance
- can be assembled in any position
- short fitting length
- control mechanism is maintenance-free

Construction :

- T- housing: smooth round tube made of galvanized steel plate, laser-welded, provided on both sides with a plug and socket connection with rolled rubber sealing ring

- valve face, valve spindle and spring made of stainless steel materials
- bearings made of synthetic material
- provided with 25 mm or 50 mm of insulation material on request
- volume control provided with servo motor: on request

Specifications description

Round air quantity controller for constant volume systems, mechanically independent operation without auxiliary power, suitable for inlets and outlets, differential pressure range to 1000 PA. Great air quantity accuracy, maintenance-free and can be fitted in any position.

Made of galvanized steel plate with plug and socket connections and rubber seals. The air volume is set at the factory, with the possibility of manually changing this setting after assembly over the whole control range by means of graduation.

Type : HNDCVR
size... mm

How to order

Volume flow controller diameter 200 mm, for an airflow of 500 m³/h

H	N	D	C	V	R	-	0	2	0	0	0	5	0	0
							Size				Airflow			

Fixing

The special plug and socket connections mean no screws or rivets are required with horizontal assembly. Can also be fitted in vertical ducts. The working of the control is insensitive to the position of assembly thanks to the special construction and suspension system.

As regards the assembly position, account must be taken of any disruption of the approaching flow due to bends or branches in ducts.

A straight approaching flow of at least three times the control diameter is recommended. If this is not respected, a slight variation in the set volume is possible.

Possible deliveries

- Possible dimensions : ø 80 mm up until ø 400 mm